

Installation Instructions

709KIT03 Drive Pinion Replacement Kit

Kit Contents:

- A - Drive Pinion
- B - Tapered Roller Bearing
- C - Brake Spring
- D - Needle Bearing
- E - Needle Bearing Washer
- F - Brake Cone
- Clutch Bearing

Tools required:

- Socket Wrench with 1/2" Socket
- Scissors

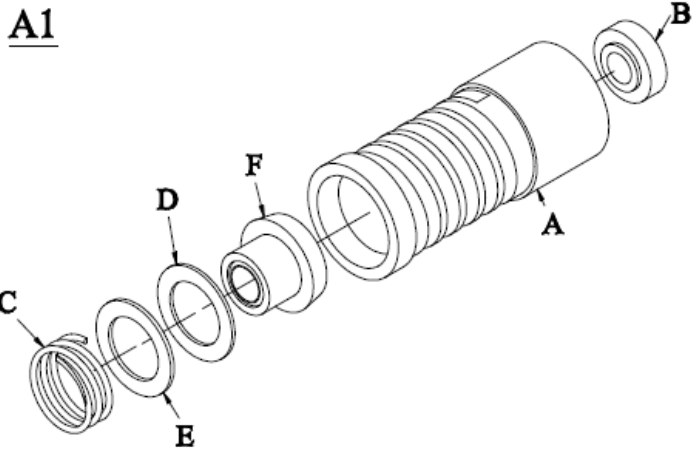

V1

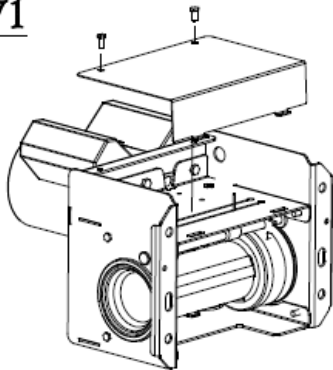

V2

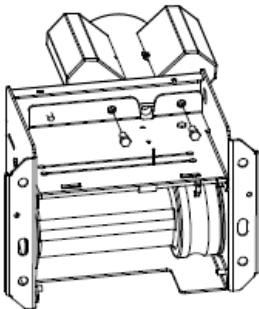

Installation Process

1 – Remove the limit cover plate as shown in V1.

2 – Orient the winch as shown in V2. Cut all the zip straps holding the wires together. Locate the wire coming from the base of the motor, through the motor plate. Only disconnect the three wires (red, blue and white) that are coming off the motor.

3 – Remove the two bolts as shown in V2, one of them holds the ground wire in place for the motor. Keep them and the ground washer separate from all other bolts.

4 – Reposition the winch so the motor is pointing up as shown in V3. Remove the three bolts shown. Remove the motor and plate together.

5 – Reposition the winch as shown in V4, so the side that was facing up in V3 is now facing down. On each end of the winch there should be 4 bolts around the rope drum. Remove only the top two on each side.

If you encounter any difficulties installing or servicing your 709 Backstop Winch, call your dealer or Porter 1-888-277-7779

PORTER

601 Mercury Drive
Champaign, IL 61822-9648
USA (800) 637-3090

INST709KIT03

V3

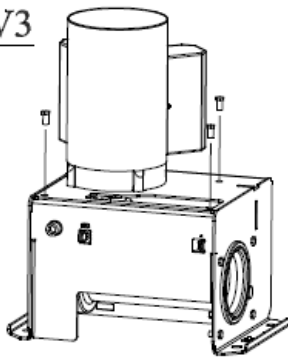

V4

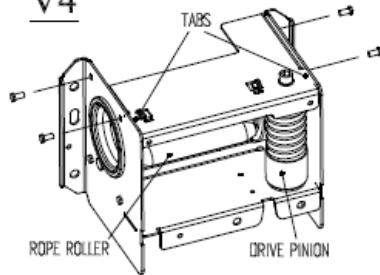

V5

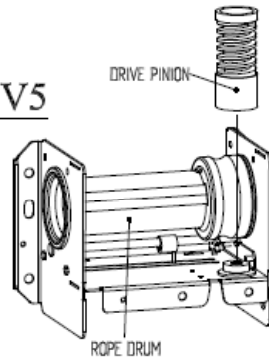

V6

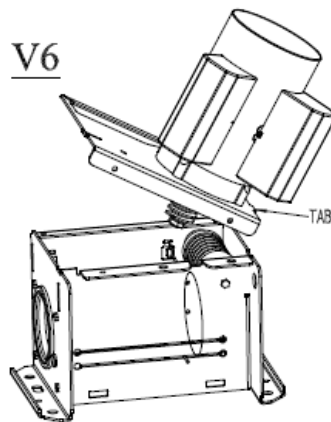

6 – Note that the white rope roller is between you and the rope drum. Remove the plate what is now at the top of the winch. You will need to pull the side plates apart slightly in order for the tabs to clear their slots.

7 – You can now remove the drive pinion as shown in V5. Also remove the bearing still on the bottom plate of the winch. Replace these with the drive pinion and bearing supplied.

9 – Replace the brake assembly on the top plate you just removed. When removing the old and installing the new brake assembly, twist it counter clockwise (left) to avoid damaging the clutch bearing. The order of parts in the brake assembly is: brake cone, needle bearing, washer, spring. See the exploded assembly A1 if you are having trouble.

8 – Replace the top plate by first sliding it into the tab on the right hand side of the winch. Make sure the brake cone in the top of the drive pinion and the white rope roller is between you and the rope drum as noted earlier and as shown in V4. Again you will need to pull the side plates apart to insert the tab on the other side of the top plate into the side plate.

9 – Replace the 4 bolts that hold the top plate in place shown in V4.

10 – Orient the winch so the drive pinion is up as shown in V6. Place one tab of the motor plate (with motor still attached) and rotate it down into position as shown in V6. This may take a few tries to get the motor wire in the notch and for the teeth to mesh properly. Re attach the three bolts shown in V3.

11 – Orient the winch as shown in V2 again. Re attach the three motor wires. Use Zip ties to hold the wires up and out of the way.

*** WARNING - When the unit is installed limits will have to be reset. If you are unsure of how to do this please consult the installation manual ***